



Asian American and Pacific Islander Educators Network

Hybrid Meeting

Monday, May 6, 2024

4:30 - 6:00 p.m.

<https://www.sccoe.org/sclis/aapi>

Welcome & Introductions



Dr. Deborah Gorgulho
Assistant Superintendent, Educational
Progress Division

Emergency Preparedness



- Identify CPR/First Aid-Certified individuals in the room
- For emergencies, dial **9-1-1** from a landline



- Notify SCCOE Staff if you require assistance exiting
- A wheelchair is available (1st Floor, North Building)



- [See the complete Emergency Plan on the SCCOE Website](#)

Emergency Evacuation Site

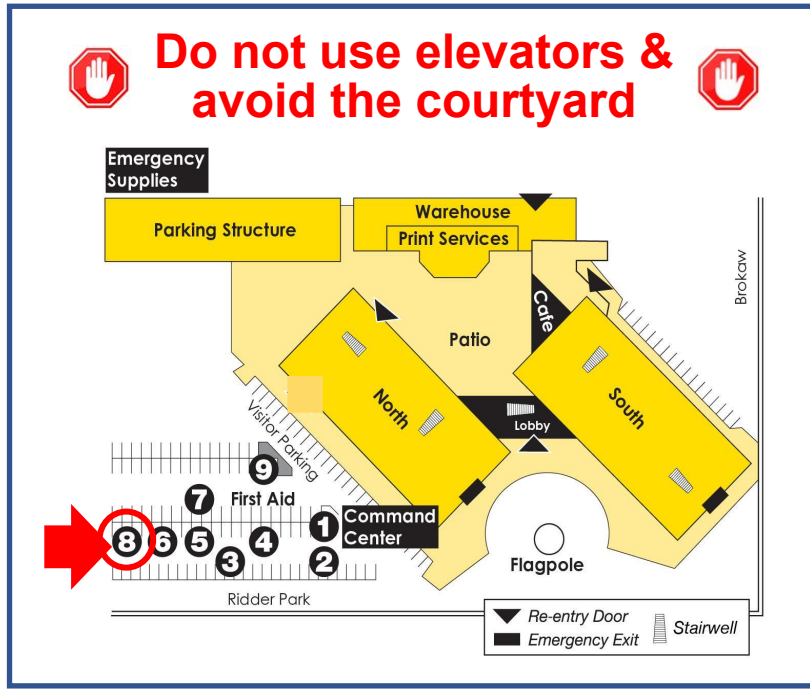

- Presenter to point out **Assembly Area 8**, 2 stairwells/exits
- Follow staff to vacate the building
- Join your group in the parking lot at Assembly Area 8
- Do not go to your car or leave the parking lot until attendance reporting is completed

Emergency Devices

Emergency devices are located on each floor at the south end of the walkways connecting North and South buildings



Fire
Extinguishers



Automated External
Defibrillator (AED)



Narcan Naloxone
Nasal Spray

Leadership, Service, & Advocacy

County Superintendent of Schools



Dr. Mary Ann Dewan

County Board of Education



Maimona Afzal Berta
Area 6



Victoria Chon
Area 5



Joseph Di Salvo
Area 4



Raeena Lari
Area 7



Grace Mah
Area 1



Don Rocha
Area 3



Tara Sreekrishnan
Area 2

Agenda

I. Welcome & Introductions

II. Facilitated Discussion: *Mental Health and Wellness Support for the School Community*

III. Discussion and Reflection

IV. Networking & Dinner

Land Acknowledgment

The AAPI Educators' Network is committed to showing respect and honoring the Indigenous Peoples of the land.

We honor and acknowledge that we are on their traditional territories and ancestral homelands. This area was also the site of trade, hunting, gathering, and healing for many other Native Nations: The Tamien [Tae mi yen], The Muwekma [Mew-Eck-Muh], Ohlone [Oh-Lone-ee], and many others.

Land Acknowledgment cont'd

We recognize the Indigenous peoples as the original stewards of the land, water, plants, and animals who called this place home.

As these words of acknowledgment are spoken and heard, the ties that these nations have to their traditional homelands are renewed and reaffirmed.

We respect the many diverse Indigenous peoples still connected to this land on which we gather. We pay our respect to them and give thanks to all Tribal Nations and the ancestors of this place.

Statement of Solidarity

The Santa Clara County Office of Education (SCCOE) in collaboration with the Asian American and Pacific Islander Educators Network affirms its commitment to...

- creating inclusive, affirming, and equitable school environments for each and every Asian American and Pacific Islander student, family, and staff of our Santa Clara County schools. This statement thus provides rationale and a foundation for operationalizing equity and social justice at the systems level for the Asian American and Pacific Islander students, families, and staff who make up our school communities.
- recognizing that the broad categories of “Asian American” and “Pacific Islander”, [when disaggregated](#), encompass a diversity of cultures, languages, religions, histories, geographical ties, immigration status, socio-economic backgrounds, and generations among over 50 ethnic groups, comprising almost [90,000 K-12 students](#) (35.3%) across Santa Clara County.

Introductions

HELLO
my name is

- Name
- Role
- District
- One Word

**Use *one* word
to describe
how you feel
right now.**



Facilitated Discussion

Mental Health and Wellness Support for the School Community

Discussion Moderator



Gena Pacada

Coordinator, Makerspace Training, Santa Clara
County Office of Education

Topic Professional



Samatra Downing, LCSW, PPSC, CWA, M.Ed.

USC Doctoral Student-K-12 Ed.D.

Coordinator of Mental Health and Wellness,
Santa Clara County Office of Education

Discussion: *Mental Health and Wellness Support for the School Community*

- **Discussion Question 1**

- Tell us about your role, who you support, and educate us about the Wellness Centers.



Discussion: *Mental Health and Wellness Support for the School Community*

- **Discussion Question 2**

- What recommendations would you give to parents, educators, and community leaders to support the mental health and well-being of AAPI students, with a focus on nurturing their creativity, imagination, and ability to dream big?



Discussion: Soul Care

- The work that you do can be very heavy at times. What do you do to make sure that you prioritize yourself and your mental health?
 - What advice/resources do you have for educators?





Discussion

Reflection

Discussion and Reflection

- What information that was shared during the facilitated discussion resonated with you?
- How can this apply to your work in education?
- Based upon what you heard tonight, what can you do as educators to respond to the needs of Asian American youth?

Discussion and Reflection

- What are the perceptions of Asian American youth?
- Why is it important to understand the narratives of Asian American students?
- What can you do as educators to respond to the needs of Asian American youth?

Networking and Dinner

Enjoy!



Planning Committee Members

- Francesca Lomotan, Santa Clara County Office of Education
- Kasturi Basu, Alum Rock Union School District
- Keysha Doutherd, Santa Clara County Office of Education
- Dr. Hong Nguyen, San Ramon Valley Unified School District
- Joanna Shea, East Side Union High School District
- Jessica Simpson, Santa Clara County Office of Education
- Jas Sohal, Santa Clara County Office of Education
- Tina Tong Choy, Berryessa Union School District
- Dr. Yee Wan, Santa Clara County Office of Education



Please Provide Feedback

<https://www.surveymonkey.com/r/aapien050624>

THANK YOU!



2024-25 Hybrid Network Meetings

4:30 to 6:00 p.m.

Monday, September 9, 2024
Thursday, November 7, 2024
Thursday, February 6, 2025
Monday, May 5, 2025



[Invite your colleagues to register!](#)



Jessica Simpson, Ed.S.

Director, School Climate, Leadership
& Instructional Services
Professional Learning & Support Division

jsimpson@sccoe.org

(408) 453-4444

Santa Clara County Office of Education

Working collaboratively with school and community partners, the **Santa Clara County Office of Education (SCCOE)** is a regional service agency committed to serving, inspiring, and promoting student and public school success. The SCCOE is a premier service organization driven by the core principles of equity, diversity, inclusion, and partnership.

For more information about the Santa Clara County Office of Education, please visit www.sccoe.org



@SCCOE



@santaclarasccoe



@santa-clara-county-
office-of-education